



## Connecting to ESU Wireless Miscellaneous Devices



### Android

1. Click the Menu button and select Settings.
2. Scroll to the top and select Wireless & Networks.
3. Make sure the that Wi-Fi selection is checked.
4. Select Wi-Fi Settings.
5. Under Wi-Fi networks you will see a list of available networks. If you see "ESU", select that to configure. If you do not see it, proceed to manual configure below.
6. In the pull-down menu of EAP Method, select PEAP.
7. In the pull-down menu of Phase 2 authentication, select MSCHAPV2.
8. Scroll past CA certificate and Client certificate.
9. In the Identity field, enter your BuzzIn username
10. Skip the Anonymous identity field.
11. In the Password field, enter your BuzzIn password. (If your cursor is stuck at Identity, click "next" on your keypad twice to get to Password).
12. Select Connect. The account settings, including username/password are now saved, and you will connect automatically when ESU is in range.

### Manual configuration of ESU Wireless

1. Scroll to the bottom and select Add Wi-Fi Network.
2. In Network SSID, enter ESU
3. Scroll down to Security and select 802.1x Enterprise.
4. Scroll down to EAP Type and select PEAP.
5. Scroll down to Phase 2 authentication and select MSCHAPV2.
6. Scroll down and enter your lastname.# in the Identity field. Skip the Anonymous Identity field, and enter your Emporia State Username password in the Wireless password field.
7. Select Save. The account settings, including username/password are now saved, and you will connect automatically when osuwireless is in range.

## Amazon Devices

Unfortunately, the regular Amazon Kindle and Kindle Paper does not support the type of wireless security and authentication used at Emporia State University. In order to connect to the Internet or the Amazon store using those devices, you must have the 3G-enabled version of the Kindle. We apologize for the inconvenience.

However the Kindle Fire and kindle Fire HD should connect to the ESU wireless network. To connect do the following:

1. Choose ESU as the Wireless network you wish to connect to.
2. Select PEAP as the EAP method.
3. Select MSCHAPV2 as the Pashe 2 Authentication
4. Leave the CA certificate and the User Certificate set to unspecified.
5. Type your ESU Buzzin user name in the Identity field.
6. Leave the Anonymous Identity field blank.
7. Type your ESU Buzzin password in the password field.
8. Click connect.

This should allow your device to connect to the ESU secure wireless network on campus.

## **Barnes & Noble Nook**

When using a Barnes & Noble NOOK and the Wi-Fi is turned on, the wireless settings page will display a list of detected Wi-Fi networks. You will notice that there is a "lock" symbol next to networks that are secure with a password. To connect to ESU:

- 1) Tap on the network name "ESU"
  
- 2) You will be prompted to enter your username and password. Enter your BuzzIn username and password
  
- 3) Tap Connect. You should now be connected to the ESU Wireless network.

## Ipad / Ipad2 / Ipod

1) Click on the Settings Icon.



2) Select Wi-Fi from the menu on the left, then select ESU from the list of networks on the right.



3) Enter your username and password. This is the same username and password as you use for Buzz In. After you've entered your username and password, click Join on the keyboard.

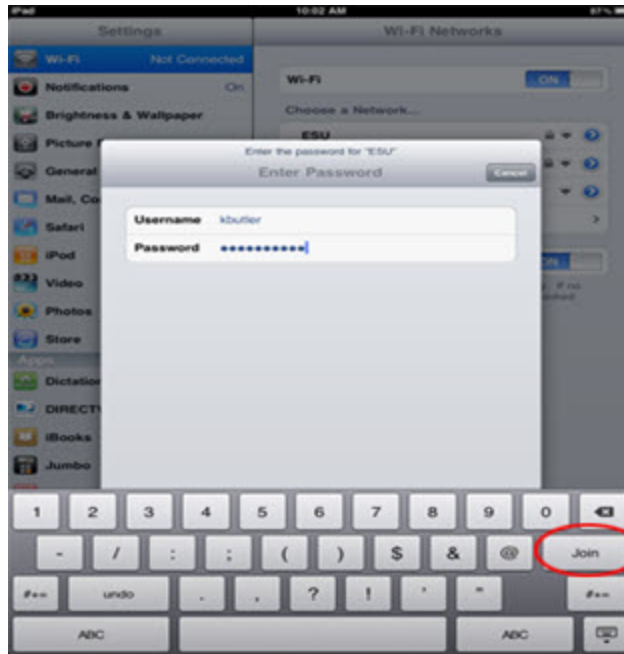

4) A security certificate will come up at this point. Click Accept on the certificate. You should now be connected to the ESU Wireless Network.

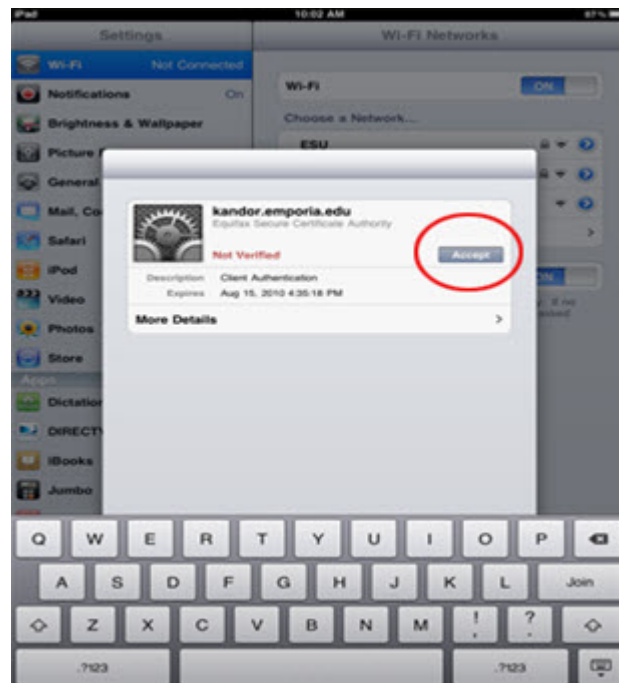

NOTE: The Apple iPad will save your credentials on the device (which means it will not prompt you for a username and password each time you connect to the ESU Wireless Network). Because of this, TCS asks that you lock your device using the built-in screen lock feature, to comply with ESU security policy.

NOTE: Because the Apple iPad saves your credentials to your device, you will have to manually disconnect from the ESU Wireless Network (using the “Forget this Network” function) each time you change your ESU password. Please remember that, by ESU security policy, you are required to change your password every 180 days.